

Imperial Positive Drive Timing Belts and Pulleys

Linear & rotary motion control

P.I.E.S. Australia Pty Ltd is the leading Australasian distributor for Synchronous timing belts and pulleys. A wholly Australian owned, family business formed in 1978, PIES is the sole Australian agents for Synchroflex®, Breco® and Brecoflex® polyurethane belting products. Pies also design, manufacture, import and export timing belts and pulleys.

CONTENTS	PAGE No.
Introduction	3
XL (0.08") Belts	4
XL (0.08") Pulleys	5
L (3/8") Belts	6
L (3/8") Pilot Bore Pulleys	7
L (3/8") Taper Lock Pulleys	9
H (1/2") Belts	11
H (1/2") Pilot Bore Pulleys	12
H (1/2") Taper Lock Pulleys	15
XH (7/8") Belts	17
XH (7/8") Pilot Bore Pulleys	18
XH (7/8") Taper Lock Pulleys	20
XXH (1.25") Belts	17

The synchronous belt drives, also called timing drives because of their geometry, represent the most modern and efficient power transmission system. They are designed to provide a practical alternative, in many application fields, to chain and, sometimes, gear drives. This drive system offers an outstanding application versatility that can be easily taken from the table. This catalogue has been tailored to provide designers with general and specific information, including construction and design features. The synchronous drives, working with a definite pitch that ensures positive synchronous conditions, have the torque rating transmitted through the tooth engagement. There is no need for high installation tension and consequently, less load on bearings is provided. The strong structure of the synchronous belts allow the realization of drives that can transmit high power transmission ratings with compact design and a quieter cleaner operation.

Applications:

- Aggregate machinery
- Packaging machinery
- Paper industry machinery
- Office equipment
- Farm machinery
- Textile machinery
- Printing trade machinery



PIES XL Rubber Timing Belts



XL (Extra Light) 1/5" pitch (5.08mm)

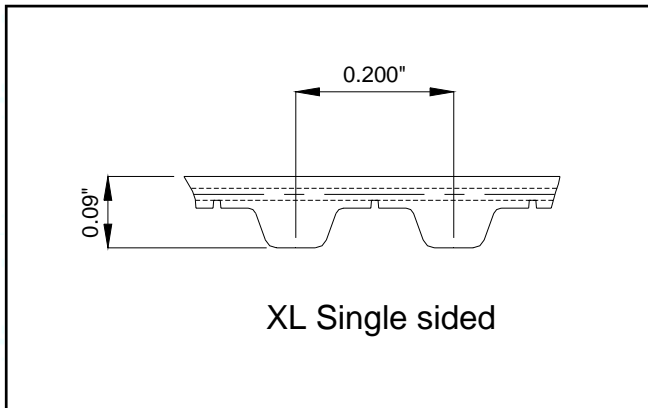

XL-DL 1/5" pitch (5.08mm)

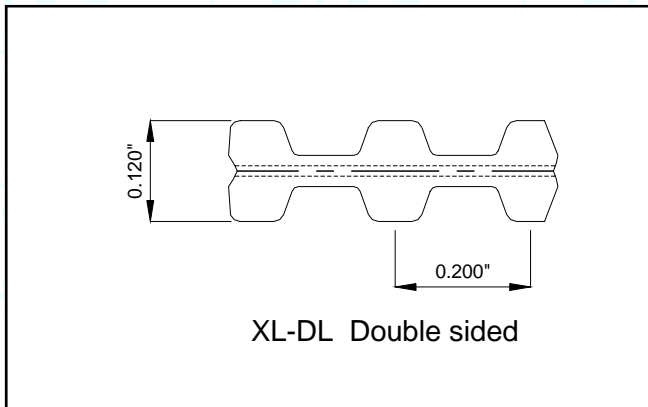

- Products marked * : Minimum quantity may apply.
- In-between lengths are available, minimum quantity may apply.
- Also available in Polyurethane, minimum quantity may apply.
- Non-standard widths available.
- Contact sales department for prices

Standard Belt widths	3/8" = 037
Example Part Number	130XL037
130	13.0" Pitch length
XL	Extra Light Pitch type
037	0.375" Wide

Belt No	Length Inches	No. Of Teeth	Belt No	Length Inches	No. Of Teeth
Single Sided			Double sided		
60XL037	6.0	30	60XL037-DL	6.0	30
70XL037	7.0	35	70XL037-DL	7.0	35
80XL037	8.0	40	80XL037-DL	8.0	40
90XL037	9.0	45	90XL037-DL	9.0	45
100XL037	10.0	50	100XL037-DL	10.0	50
110XL037	11.0	55	110XL037-DL	11.0	55
120XL037	12.0	60	120XL037-DL	12.0	60
130XL037	13.0	65	130XL037-DL	13.0	65
140XL037	14.0	70	140XL037-DL	14.0	70
142XL037	14.2	71	150XL037-DL	15.0	75
150XL037	15.0	75	160XL037-DL	16.0	80
160XL037	16.0	80	170XL037-DL	17.0	85
170XL037	17.0	85	180XL037-DL	18.0	90
180XL037	18.0	90	190XL037-DL	19.0	95
190XL037	19.0	95	200XL037-DL	20.0	100
200XL037	20.0	100	210XL037-DL	21.0	105
202XL037	20.2	101	220XL037-DL	22.0	110
210XL037	21.0	105	230XL037-DL	23.0	115
220XL037	22.0	110	240XL037-DL	24.0	120
228XL037	22.8	114	250XL037-DL	25.0	125
230XL037	23.0	115	260XL037-DL	26.0	130
240XL037	24.0	120	280XL037-DL	28.0	140
250XL037	25.0	125	290XL037-DL	29.0	145
260XL037	26.0	130	300XL037-DL	30.0	150
270XL037	27.0	135	310XL037-DL*	31.0	155
290XL037	29.0	145	330XL037-DL*	33.0	165
300XL037	30.0	150	364XL037-DL*	36.4	182
310XL037	31.0	155	380XL037-DL*	38.0	190
316XL037	31.6	158	390XL037-DL*	39.0	195
322XL037	32.2	161	392XL037-DL*	39.2	196
330XL037	33.0	165	450XL037-DL*	45.0	225
380XL037	38.0	190	492XL037-DL*	49.2	246
390XL037	39.0	195	690XL037-DL*	69.0	345
434XL037	43.4	217	900XL037-DL*	90.0	450
530XL037*	53.0	265			
600XL037*	60.0	300			
630XL037*	63.0	315			
710XL037*	71.0	355			

Also available is a range of **MXL (0.08" / 2.032mm)** Pitch timing belts and pulleys. Please see the **PIES Polyurethane Timing Belt** Catalogue or contact our sales department for sizes and availability.

XL 1/5" Pitch

XL037 Pilot Bore Pulley

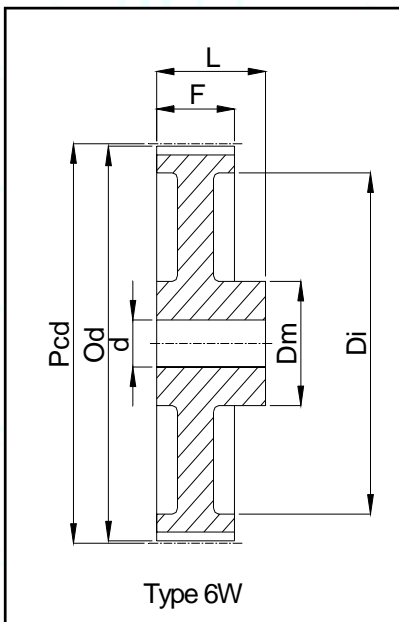
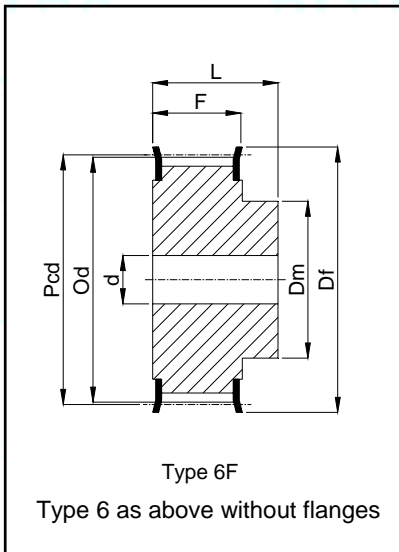

Pulley No.		Type	teeth	Pcd	Od	Dm	Df (Di)	F	L	d	Weight
10XL037F	ALUMINIUM	6F	10	16.17	15.66	9.5	23	14.3	20	-	0.010
12XL037F		6F	12	19.40	18.90	10	25	14.3	20	-	0.010
14XL037F		6F	14	22.64	22.13	15	28	14.3	20	-	0.017
15XL037F		6F	15	24.26	23.75	15	28	14.3	20	-	0.018
16XL037F		6F	16	25.87	25.36	16	32	14.3	20	-	0.027
18XL037F		6F	18	29.11	28.60	20	35	14.3	20	-	0.033
19XL037F		6F	19	30.72	30.22	20	35	14.3	22	-	0.036
20XL037F		6F	20	32.34	31.83	23.5	38	14.3	22	-	0.040
21XL037F		6F	21	33.96	33.45	23.5	38	14.3	22	-	0.043
22XL037F		6F	22	35.57	35.07	25	41	14.3	22	6	0.046
24XL037F		6F	24	38.81	38.30	30	44	14.3	22	6	0.054
25XL037F		6F	25	40.43	39.92	30	48	14.3	22	6	0.062
26XL037F		6F	26	42.04	41.53	30	48	14.3	22	8	0.065
27XL037F		6F	27	43.66	43.15	30	48	14.3	22	8	0.071
28XL037F		6F	28	45.28	44.77	34	51	14.3	22	8	0.076
30XL037F		6F	30	48.51	48.00	38	54	14.3	22	8	0.091
32XL037F		6F	32	51.74	51.24	38	57	14.3	25	8	0.100
36XL037F		6F	36	58.21	57.70	45	66	14.3	25	8	0.150
40XL037F		6F	40	64.68	64.17	45	71	14.3	25	8	0.170
44XL037		6	44	71.15	70.64	45	-	14.3	25	8	0.200
48XL037		6W	48	77.62	77.11	45	(61)	14.3	25	10	0.200
60XL037		6W	60	97.02	96.51	45	(80)	14.3	25	10	0.240
72XL037		6W	72	116.42	115.92	45	(100)	14.3	25	10	0.310

- In between sizes can be specially manufactured.
- All XL pulleys are stocked in aluminium, but some steel ones are available. Please enquire with our sales staff.

PIES L Rubber Timing Belts



L (Light) 3/8" pitch (9.525mm)

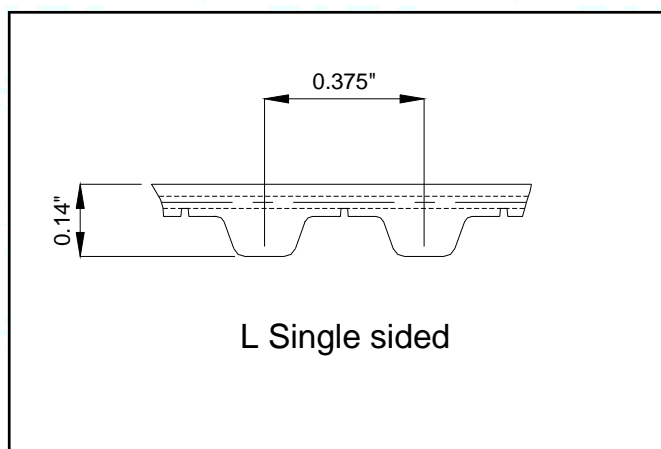

L-DL 3/8" pitch (9.525mm)

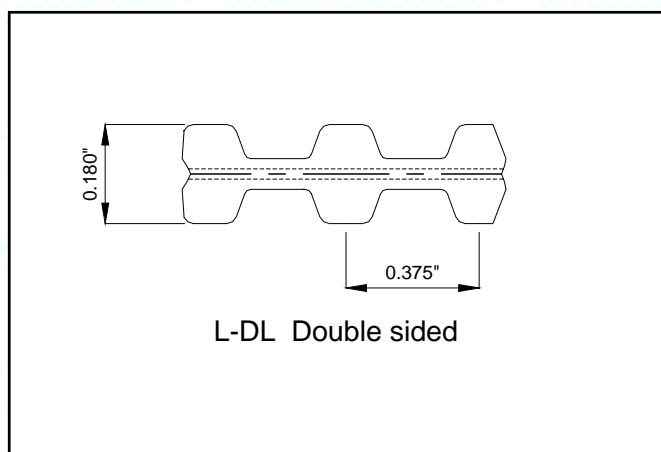

- Products marked * : Minimum quantity may apply.
- In-between lengths are available, minimum quantity may apply.
- Also available in Polyurethane, minimum quantity may apply.
- Non-standard widths available.
- Contact sales department for prices
- Pulleys have a Phosphated finish.

Standard Belt widths	1/2" = 050	3/4" = 075	1" = 100
Example Part Number	255L075		
255	25.5" Pitch length		
L	Light Pitch type		
075	0.750" Wide		

Belt No	Length Inches	No. Of Teeth	Belt No	Length Inches	No. Of Teeth
Single Sided			Double sided		
124 L	12.37	33	124 L - DL	12.37	33
135 L	13.50	36	150 L - DL	15.00	40
150 L	15.00	40	187 L - DL	18.75	50
165 L	16.50	44	210 L - DL	21.00	56
173 L	17.25	46	225 L - DL	22.50	60
187 L	18.75	50	240 L - DL	24.00	64
210 L	21.00	56	255 L - DL	25.50	68
225 L	22.50	60	270 L - DL	27.00	72
240 L	24.00	64	285 L - DL	28.50	76
255 L	25.50	68	300 L - DL	30.00	80
270 L	27.00	72	322 L - DL	32.25	86
285 L	28.50	76	345 L - DL	34.50	92
300 L	30.00	80	367 L - DL	36.75	98
322 L	32.25	86	390 L - DL	39.00	104
345 L	34.50	92	420 L - DL	42.00	112
367 L	36.75	98	450 L - DL	45.00	120
390 L	39.00	104	480 L - DL	48.00	128
420 L	42.00	112	510 L - DL	51.00	136
450 L	45.00	120	540 L - DL	54.00	144
480 L	48.00	128	600 L - DL	60.00	160
510 L	51.00	136	660 L - DL	66.00	176
540 L	54.00	144			
600 L	60.00	160			
660 L	66.00	176			
728 L*	72.75	194			
817 L*	81.75	218			
840 L*	84.00	224			

L 3/8" Pitch

L050 Pilot Bore Pulley

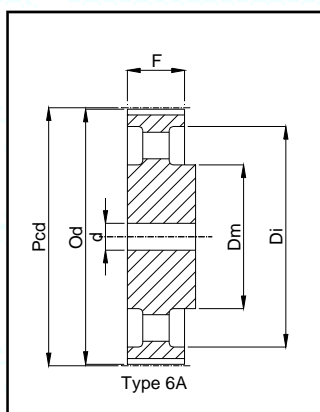
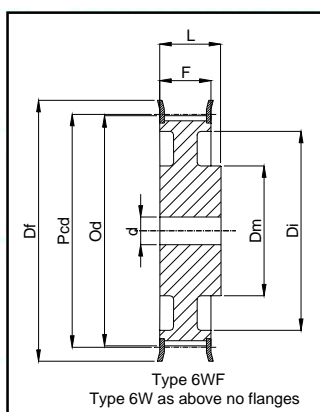
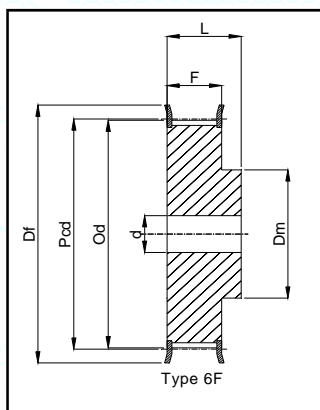

Pulley No.		Type	teeth	Pcd	Od	Dm	Df	Di	F	L	d	Weight
10L050F	STEEL	6F	10	30.32	29.56	20	37	-	19	28	8	0.120
11L050F		6F	11	33.35	32.59	22	37	-	19	30	8	0.150
12L050F		6F	12	36.38	35.62	24	43	-	19	30	8	0.180
13L050F		6F	13	39.41	38.65	28	44	-	19	30	8	0.220
14L050F		6F	14	42.45	41.68	28	48	-	19	30	8	0.250
15L050F		6F	15	45.48	44.72	34	51	-	19	30	8	0.300
16L050F		6F	16	48.51	47.75	36	54	-	19	32	8	0.360
17L050F		6F	17	51.54	50.78	36	57	-	19	32	10	0.390
18L050F		6F	18	54.57	53.81	40	60	-	19	32	10	0.450
19L050F		6F	19	57.61	56.84	40	64	-	19	32	10	0.480
20L050F		6F	20	60.64	59.88	40	66	-	19	32	10	0.540
21L050F		6F	21	63.67	62.91	45	70	-	19	32	10	0.610
22L050F		6F	22	66.70	65.94	45	75	-	19	32	10	0.660
23L050F		6F	23	69.73	68.97	55	79	-	19	32	10	0.800
24L050F		6F	24	72.77	72.00	55	79	-	19	32	10	0.830
25L050F		6F	25	75.80	75.04	58	83	-	19	32	10	0.910
26L050F		6F	26	78.83	78.07	58	86	-	19	32	11	0.970
27L050F		6F	27	81.86	81.10	58	86	-	19	32	11	1.010
28L050F		6F	28	84.89	84.13	58	91	-	19	32	11	1.080
30L050F		6F	30	90.96	90.20	70	97	-	19	32	11	1.200
32L050F		6F	32	97.02	96.26	70	102	-	19	32	11	1.390
36L050F		6F	36	109.15	108.39	70	115	-	19	32	11	1.520
40L050F		6WF	40	121.28	120.51	70	128	100	19	32	11	1.500
42L050F		6WF	42	127.34	126.58	70	135	106	19	32	11	1.590
48L050F		6WF	48	145.53	144.77	70	150	124	19	32	11	1.710
60L050	CAST IRON	6W	60	181.91	181.15	75	-	160	19	42	14	2.940
72L050		6A	72	218.30	217.53	75	-	197	19	42	14	2.710
84L050		6A	84	254.68	253.92	75	-	233	19	42	14	3.800
96L050		6A	96	291.06	290.30	75	-	269	19	42	14	4.200
120L050		6A	120	363.83	363.07	75	-	342	19	42	14	5.850

L075 Pilot Bore Pulley

Pulley No.		Type	teeth	Pcd	Od	Dm	Df	Di	F	L	d	Weight
10L075F	STEEL	6F	10	30.32	29.56	20	37	-	25.4	38	8	0.16
11L075F		6F	11	33.35	32.59	22	37	-	25.4	38	8	0.20
12L075F		6F	12	36.38	35.62	24	43	-	25.4	38	8	0.23
13L075F		6F	13	39.41	38.65	28	44	-	25.4	38	8	0.28
14L075F		6F	14	42.45	41.68	28	48	-	25.4	38	11	0.32
15L075F		6F	15	45.48	44.72	34	51	-	25.4	38	11	0.39
16L075F		6F	16	48.51	47.75	36	54	-	25.4	38	11	0.44
17L075F		6F	17	51.54	50.78	36	57	-	25.4	38	11	0.49
18L075F		6F	18	54.57	53.81	40	60	-	25.4	38	11	0.55
19L075F		6F	19	57.61	56.84	40	64	-	25.4	38	11	0.60
20L075F		6F	20	60.64	59.88	40	66	-	25.4	38	11	0.66
21L075F		6F	21	63.67	62.91	45	70	-	25.4	38	11	0.76
22L075F		6F	22	66.70	65.94	45	75	-	25.4	38	11	0.82
23L075F		6F	23	69.73	68.97	55	79	-	25.4	38	11	0.97
24L075F		6F	24	72.77	72.00	55	79	-	25.4	38	11	1.02
25L075F		6F	25	75.80	75.04	58	83	-	25.4	38	11	1.11
26L075F		6F	26	78.83	78.07	58	86	-	25.4	38	11	1.19
27L075F		6F	27	81.86	81.10	58	86	-	25.4	38	11	1.25
28L075F		6F	28	84.89	84.13	58	91	-	25.4	38	11	1.33
30L075F		6F	30	90.96	90.20	70	97	-	25.4	38	11	1.41
32L075F		6F	32	97.02	96.26	70	102	-	25.4	38	11	1.50
36L075F		6F	36	109.15	108.39	70	115	-	25.4	38	11	1.92
40L075F		6WF	40	121.28	120.51	70	128	100	25.4	38	11	1.75
42L075F		6WF	42	127.34	126.58	70	135	106	25.4	38	11	1.84
48L075F		6WF	48	145.53	144.77	70	150	124	25.4	38	11	2.10
60L075	CAST IRON	6W	60	181.91	181.15	75	-	160	25.4	45	14	3.18
72L075		6A	72	218.30	217.53	75	-	197	25.4	45	14	3.21
84L075		6A	84	254.68	253.92	75	-	233	25.4	45	14	4.00
96L075		6A	96	291.06	290.30	75	-	269	25.4	45	14	4.60
120L075		6A	120	363.83	363.07	75	-	342	25.4	45	14	7.40

L 3/8" Pitch

L100 Pilot Bore Pulley

Pulley No.		Type	teeth	Pcd	Od	Dm	Df	Di	F	L	d	Weight
10L100F	STEEL	6F	10	30.32	29.56	20	37	-	31.8	45	8	0.190
11L100F		6F	11	33.35	32.59	22	37	-	31.8	45	8	0.240
12L100F		6F	12	36.38	35.62	24	43	-	31.8	45	8	0.280
13L100F		6F	13	39.41	38.65	28	44	-	31.8	45	8	0.340
14L100F		6F	14	42.45	41.68	28	48	-	31.8	45	11	0.380
15L100F		6F	15	45.48	44.72	34	51	-	31.8	45	11	0.460
16L100F		6F	16	48.51	47.75	36	54	-	31.8	45	11	0.530
17L100F		6F	17	51.54	50.78	36	57	-	31.8	45	11	0.580
18L100F		6F	18	54.57	53.81	40	60	-	31.8	45	11	0.660
19L100F		6F	19	57.61	56.84	40	64	-	31.8	45	11	0.720
20L100F		6F	20	60.64	59.88	40	66	-	31.8	45	11	0.800
21L100F		6F	21	63.67	62.91	45	70	-	31.8	45	11	0.910
22L100F		6F	22	66.70	65.94	45	75	-	31.8	45	11	0.990
23L100F		6F	23	69.73	68.97	55	79	-	31.8	45	11	1.150
24L100F		6F	24	72.77	72.00	55	79	-	31.8	45	11	1.220
25L100F		6F	25	75.80	75.04	58	83	-	31.8	45	11	1.340
26L100F		6F	26	78.83	78.07	58	86	-	31.8	45	11	1.440
27L100F		6F	27	81.86	81.10	58	86	-	31.8	45	11	1.510
28L100F		6F	28	84.89	84.13	58	91	-	31.8	45	11	1.610
30L100F		6F	30	90.96	90.20	70	97	-	31.8	45	11	1.720
32L100F		6F	32	97.02	96.26	70	102	-	31.8	45	11	2.100
36L100F		6F	36	109.15	108.39	70	115	-	31.8	45	11	2.340
40L100F		6WF	40	121.28	120.51	70	128	100	31.8	45	11	2.000
42L100F		6WF	42	127.34	126.58	70	135	106	31.8	45	11	2.090
48L100F		6WF	48	145.53	144.77	70	150	124	31.8	45	11	2.500
60L100	CAST IRON	6W	60	181.91	181.15	75	-	160	31.8	50	14	3.580
72L100		6A	72	218.30	217.53	75	-	197	31.8	50	14	3.890
84L100		6A	84	254.68	253.92	75	-	233	31.8	50	14	4.730
96L100		6A	96	291.06	290.30	75	-	269	31.8	50	14	4.900
120L100		6A	120	363.83	363.07	75	-	342	31.8	50	14	8.400

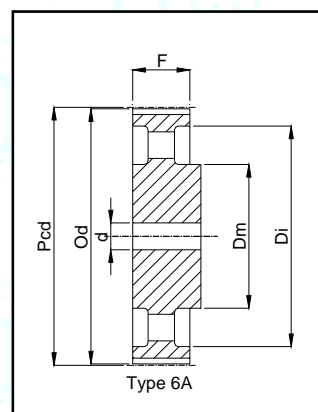
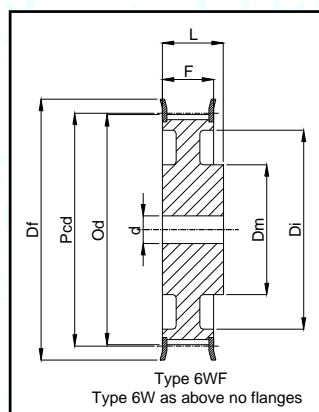
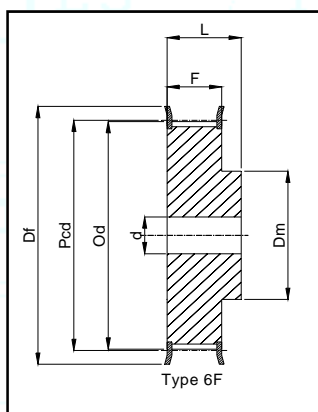

L 3/8" Pitch

L050 Taper Lock Bore Pulley

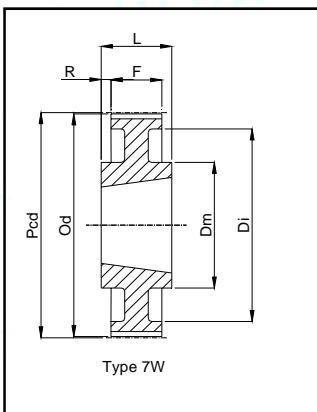
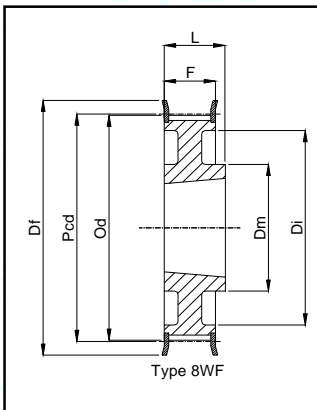
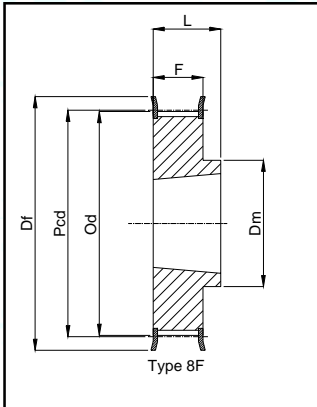

Pulley No.		Type	teeth	Pcd	Od	Dm	Df	Di	F	L	R	Weight
18L050F-1108	STEEL	8F	18	54.57	53.81	45	60	-	19	22	-	0.19
19L050F-1108		8F	19	57.61	56.84	45	64	-	19	22	-	0.21
20L050F-1108		8F	20	60.64	59.88	48	66.5	-	19	22	-	0.26
21L050F-1108		8F	21	63.67	62.91	48	70	-	19	22	-	0.31
22L050F-1108		8F	22	66.70	65.94	51	75	-	19	22	-	0.36
23L050F-1108		8F	23	69.73	68.97	54	79	-	19	22	-	0.42
24L050F-1108		8F	24	72.77	72.00	54	79	-	19	22	-	0.42
25L050F-1108		8F	25	75.80	75.04	56	82.5	-	19	22	-	0.48
26L050F-1108		8F	26	78.83	78.07	60	86	-	19	22	-	0.54
27L050F-1108		8F	27	81.86	81.10	62	86	-	19	22	-	0.57
28L050F-1108		8F	28	84.89	84.13	65	91	-	19	22	-	0.64
30L050F-1108		8F	30	90.96	90.20	70	97	-	19	22	-	0.76
32L050F-1108		8F	32	97.02	96.26	74	102	-	19	22	-	0.91
36L050F-1108		8F	36	109.15	108.39	85	115	-	19	22	-	1.20
40L050F-1610		8F	40	121.28	120.51	97	128	-	19	25	-	1.50
48L050F-1610		8WF	48	145.53	144.77	88	150	120	19	25	-	1.63
60L050 -1610	7W		60	181.91	181.15	92	-	166	19	25	3.0	2.01
72L050 -1610	CAST IRON	7A	72	218.30	217.53	92	-	202	19	25	3.0	2.20
84L050 -1610		7A	84	254.68	253.92	92	-	236	19	25	3.0	2.93
96L050 -2012		7A	96	291.06	290.30	106	-	270	19	32	6.5	4.20
120L050 -2012		7A	120	363.83	363.07	106	-	343	19	32	6.5	6.00

L075 Taper Lock Bore Pulley

Pulley No.		Type	teeth	Pcd	Od	Dm	Df	Di	F	L	R	Weight
18L075F-1108	STEEL	3F	18	54.57	53.81	-	60	-	25	-	-	0.22
19L075F-1108		3F	19	57.61	56.84	-	64	-	25	-	-	0.25
20L075F-1108		3F	20	60.64	59.88	-	66.5	-	25	-	-	0.32
21L075F-1108		3F	21	63.67	62.91	-	70	-	25	-	-	0.38
22L075F-1108		3F	22	66.70	65.94	-	75	-	25	-	-	0.44
23L075F-1108		3F	23	69.73	68.97	-	79	-	25	-	-	0.47
24L075F-1108		3F	24	72.77	72.00	-	79	-	25	-	-	0.50
25L075F-1108		3F	25	75.80	75.04	-	82.5	-	25	-	-	0.60
26L075F-1108		3F	26	78.83	78.07	-	86	-	25	-	-	0.65
27L075F-1108		3F	27	81.86	81.10	-	86	-	25	-	-	0.70
28L075F-1108		3F	28	84.89	84.13	-	91	-	25	-	-	0.78
30L075F-1108		3F	30	90.96	90.20	-	97	-	25	-	-	0.92
32L075F-1108		3F	32	97.02	96.26	-	102	-	25	-	-	1.08
36L075F-1610		3F	36	109.15	108.39	-	115	-	25	-	-	1.20
40L075F-1610		3F	40	121.28	120.51	-	128	-	25	-	-	1.60
48L075F-1610		3WF	48	145.53	144.77	92	150	120	25	-	-	1.66
60L075 -1610	60		181.91	181.15	92	-	166	25	-	-	1.88	
72L075 -1610	CAST IRON	3A	72	218.30	217.53	92	-	202	25	-	-	2.60
84L075 -2012		7A	84	254.68	253.92	106	-	236	25	32	3.5	3.80
96L075 -2012		7A	96	291.06	290.30	106	-	270	25	32	3.5	4.60
120L075-2012		7A	120	363.83	363.07	106	-	343	25	32	3.5	6.50

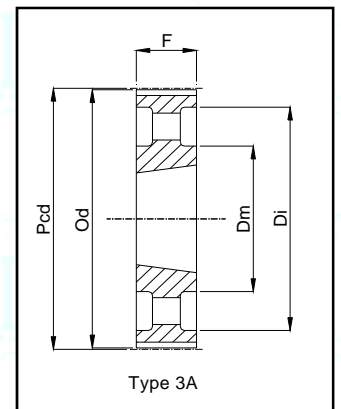
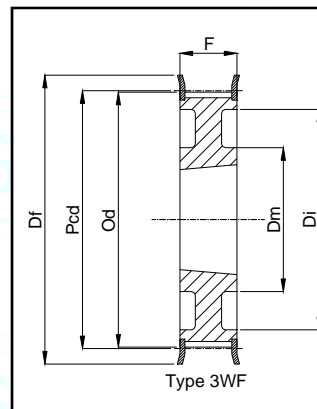
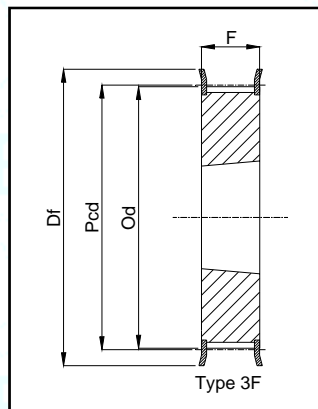
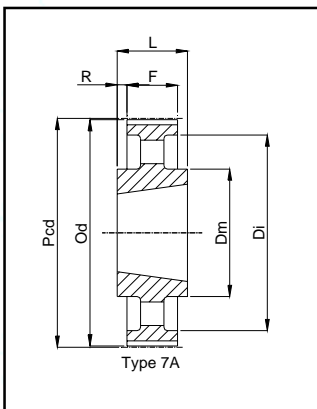

L 3/8" Pitch

L100 Taper Lock Bore Pulley

Pulley No.		Type	teeth	Pcd	Od	Dm	Df	Di	F	S	R	Weight
18L100F-1108	STEEL	5F	18	54.57	53.81	-	60	38	31	22	9.0	0.26
19L100F-1108		5F	19	57.61	56.84	-	64	38	31	22	9.0	0.31
20L100F-1108		5F	20	60.64	59.88	-	66.5	45	31	22	9.0	0.35
21L100F-1108		5F	21	63.67	62.91	-	70	45	31	22	9.0	0.42
22L100F-1108		5F	22	66.70	65.94	-	75	48	31	22	9.0	0.47
23L100F-1108		5F	23	69.73	68.97	-	79	52	32	22	10.0	0.51
24L100F-1108		5F	24	72.77	72.00	-	79	52	32	22	10.0	0.57
25L100F-1108		5F	25	75.80	75.04	-	82.5	54	32	22	10.0	0.65
26L100F-1108		5F	26	78.83	78.07	-	86	60	32	22	10.0	0.70
27L100F-1108		5F	27	81.86	81.10	-	86	60	32	22	10.0	0.75
28L100F-1108		5F	28	84.89	84.13	-	91	65	32	22	10.0	0.83
30L100F-1210		5F	30	90.96	90.20	-	97	71	32	25	7.0	0.90
32L100F-1210		5F	32	97.02	96.26	-	102	75	32	25	7.0	1.10
36L100F-1610		5F	36	109.15	108.39	-	115	86	32	25	7.0	1.28
40L100F-1610		5F	40	121.28	120.51	-	128	96	32	25	7.0	1.72
48L100F-1610	CAST IRON	5WF	48	145.53	144.77	92.0	150	120	32	25	7.0	2.00
60L100 -1610		9W	60	181.91	181.15	92.0	-	166	32	25	3.5	2.10
72L100 -2012	CAST IRON	3A	72	218.30	217.53	106.0	-	202	32	32	-	3.00
84L100 -2012		3A	84	254.68	253.92	106.0	-	236	32	32	-	4.40
96L100 -2012		3A	96	291.06	290.30	106.0	-	270	32	32	-	5.10
120L100 -2012		3A	120	363.83	363.07	106.0	-	343	32	32	-	7.00

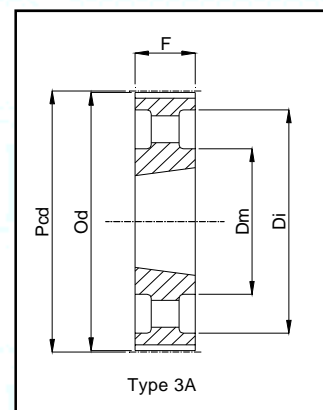
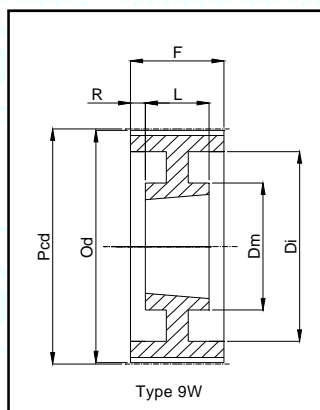
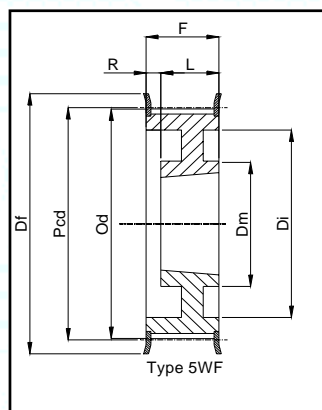
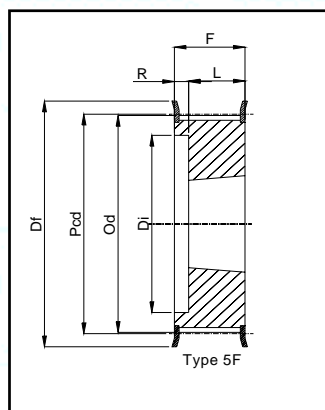

PIES H Rubber Timing Belts



H (HEAVY) 1/2" pitch (12.7mm)

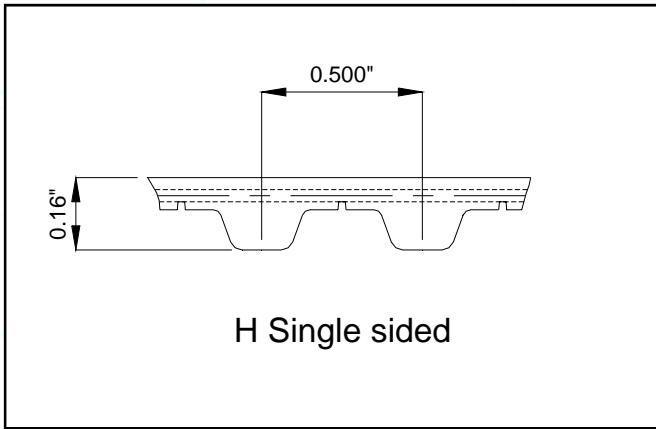

H-DL 1/2" pitch (12.7mm)

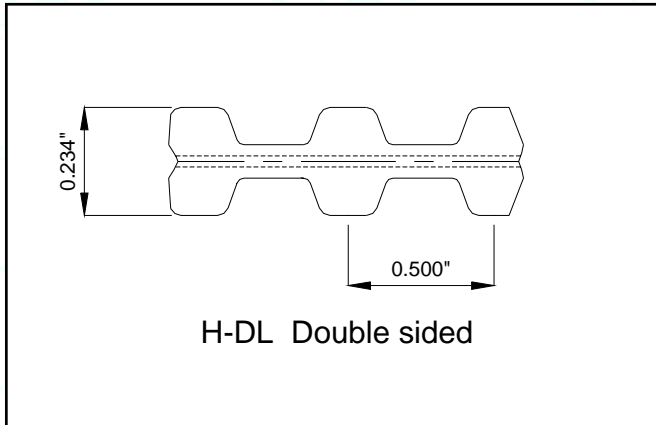

- In-between lengths are available, minimum quantity may apply.
- Also available in Polyurethane, minimum quantity may apply.
- Non-standard widths available.
- Contact sales department for prices
- Pulleys have a Phosphated finish.

Standard Belt widths	3/4" = 075	1" = 100	1.5" = 150	2" = 200	3" = 300
Example Part Number	700H200				
700	70.0" Pitch length				
H	Heavy Pitch type				
200	2.00" Wide				

Belt No	Length Inches	No. Of Teeth	Belt No	Length Inches	No. Of Teeth
Single Sided			Double sided		
230 H	23.0	46	240 H - DL	24.0	48
240 H	24.0	48	270 H - DL	27.0	54
270 H	27.0	54	300 H - DL	30.0	60
300 H	30.0	60	330 H - DL	33.0	66
330 H	33.0	66	360 H - DL	36.0	72
360 H	36.0	72	390 H - DL	39.0	78
390 H	39.0	78	420 H - DL	42.0	84
420 H	42.0	84	450 H - DL	45.0	90
450 H	45.0	90	480 H - DL	48.0	96
480 H	48.0	96	510 H - DL	51.0	102
490 H	49.0	98	540 H - DL	54.0	108
510 H	51.0	102	570 H - DL	57.0	114
540 H	54.0	108	600 H - DL	60.0	120
570 H	57.0	114	630 H - DL	63.0	126
585 H	58.5	117	660 H - DL	66.0	132
600 H	60.0	120	700 H - DL	70.0	140
630 H	63.0	126	750 H - DL	75.0	150
660 H	66.0	132	800 H - DL	80.0	160
700 H	70.0	140	850 H - DL	85.0	170
730 H	73.0	146	900 H - DL	90.0	180
750 H	75.0	150	1000 H - DL	100.0	200
800 H	80.0	160	1100 H - DL	110.0	220
850 H	85.0	170	1250 H - DL	125.0	250
900 H	90.0	180	1400 H - DL	140.0	280
960 H	96.0	192	1700 H - DL	170.0	340
1000 H	100.0	200			
1150 H	115.0	230			
1100 H	110.0	220			
1250 H	125.0	250			
1400 H	140.0	280			
1700 H	170.0	340			

H 1/2" Pitch

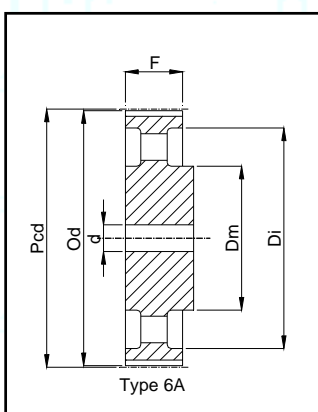
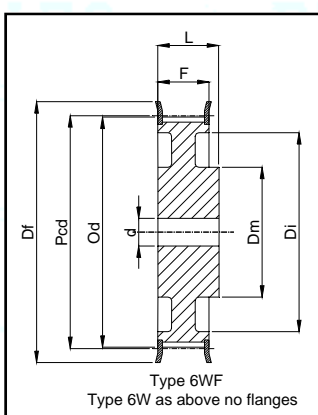
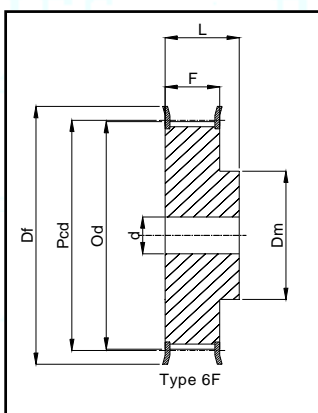

H075 Pilot Bore Pulley

Pulley No.		Type	teeth	Pcd	Od	Dm	Df	Di	F	L	d	Weight
14H075F	STEEL	6F	14	56.60	55.22	40	64	-	26.4	40	-	0.60
15H075F		6F	15	60.64	59.27	45	66.5	-	26.4	40	-	0.71
16H075F		6F	16	64.68	63.31	45	70	-	26.4	40	-	0.80
17H075F		6F	17	68.72	67.35	45	75	-	26.4	40	-	0.88
18H075F		6F	18	72.77	71.39	55	79	-	26.4	40	-	1.05
19H075F		6F	19	76.81	75.44	60	82.5	-	26.4	40	11	1.19
20H075F		6F	20	80.85	79.48	62	87	-	26.4	40	11	1.29
21H075F		6F	21	84.89	83.52	65	91	-	26.4	40	11	1.44
22H075F		6F	22	88.94	87.56	68	94	-	26.4	40	11	1.58
23H075F		6F	23	92.98	91.61	72	97	-	26.4	40	11	1.74
24H075F		6F	24	97.02	95.65	72	102	-	26.4	40	11	1.87
25H075F		6F	25	101.06	99.69	72	106	-	26.4	40	11	1.78
26H075F		6F	26	105.11	103.73	80	112	-	26.4	40	11	2.03
27H075F		6F	27	109.15	107.78	80	115	-	26.4	40	11	2.15
28H075F		6F	28	113.19	111.82	80	120	-	26.4	40	11	2.27
30H075F		6F	30	121.28	119.90	80	128	-	26.4	40	11	2.56
32H075F		6F	32	129.36	127.99	80	135	-	26.4	40	11	2.86
34H075F		6F	34	137.45	136.07	80	142	-	26.4	40	11	3.16
35H075F		6F	35	141.49	140.12	80	150	-	26.4	40	11	3.30
36H075F		6F	36	145.53	144.16	80	150	-	26.4	40	11	2.71
38H075F		6F	38	153.62	152.24	80	158	-	26.4	40	11	2.76
40H075F		6F	40	161.70	160.33	80	168	-	26.4	40	11	2.77
44H075F	CAST IRON	6WF	44	177.87	176.50	80	184	150	26.4	40	14	3.18
48H075F		6WF	48	194.04	192.67	90	200	166	26.4	45	14	4.14

H100 Pilot Bore Pulley

Pulley No.		Type	teeth	Pcd	Od	Dm	Df	Di	F	L	d	Weight
14H100F	STEEL	6F	14	56.60	55.22	40	64	-	31.8	45	-	0.69
15H100F		6F	15	60.64	59.27	45	66.5	-	31.8	45	-	0.81
16H100F		6F	16	64.68	63.31	45	70	-	31.8	45	-	0.91
17H100F		6F	17	68.72	67.35	45	75	-	31.8	45	-	1.01
18H100F		6F	18	72.77	71.39	55	79	-	31.8	45	-	1.20
19H100F		6F	19	76.81	75.44	60	82.5	-	31.8	45	14	1.36
20H100F		6F	20	80.85	79.48	62	87	-	31.8	45	14	1.50
21H100F		6F	21	84.89	83.52	66	91	-	31.8	45	14	1.65
22H100F		6F	22	88.94	87.56	68	94	-	31.8	45	14	1.82
23H100F		6F	23	92.98	91.61	72	97	-	31.8	45	14	1.99
24H100F		6F	24	97.02	95.65	72	102	-	31.8	45	14	2.15
25H100F		6F	25	101.06	99.69	72	106	-	31.8	45	14	2.05
26H100F		6F	26	105.11	103.73	80	112	-	31.8	45	14	2.30
27H100F		6F	27	109.15	107.78	80	115	-	31.8	45	14	2.46
28H100F		6F	28	113.19	111.82	80	120	-	31.8	45	14	2.61
30H100F		6F	30	121.28	119.90	80	128	-	31.8	45	14	2.90
32H100F		6F	32	129.36	127.99	80	135	-	31.8	45	14	3.29
34H100F		6F	34	137.45	136.07	80	142	-	31.8	45	14	3.70
35H100F		6F	35	141.49	140.12	80	150	-	31.8	45	14	3.86
36H100F		6F	36	145.53	144.16	80	150	-	31.8	45	14	3.10
38H100F		6F	38	153.62	152.24	80	158	-	31.8	45	14	3.22
40H100F		6F	40	161.70	160.33	80	168	-	31.8	45	14	3.37
44H100F	CAST IRON	6WF	44	177.87	176.50	80	184	150	31.8	50	14	4.41
48H100F		6WF	48	194.04	192.67	90	200	166	31.8	50	14	4.80
60H100		6A	60	242.55	241.18	120	-	215	31.8	50	19	6.20
72H100		6A	72	291.06	289.69	120	-	263	31.8	55	19	7.00
84H100		6A	84	339.57	338.20	120	-	312	31.8	55	19	8.50
96H100		6A	96	388.08	386.71	120	-	360	31.8	60	19	12.50
120H100		6A	120	485.10	483.73	120	-	458	31.8	60	19	19.60

PIES H Timing Pulleys



H 1/2" Pitch

H150 Pilot Bore Pulley

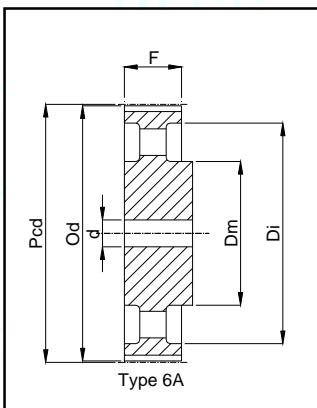
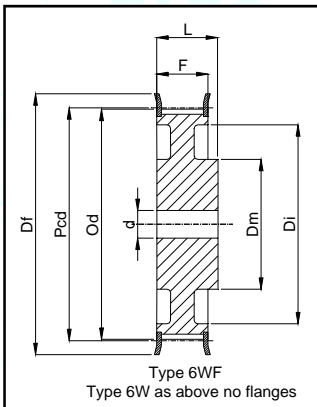
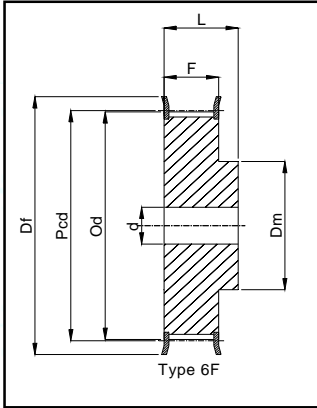

Pulley No.		Type	teeth	Pcd	Od	Dm	Df	Di	F	L	d	Weight
14H150F	STEEL	6F	14	56.60	55.22	42	64	-	46	58	-	0.93
15H150F		6F	15	60.64	59.27	45	66.5	-	46	58	-	1.08
16H150F		6F	16	64.68	63.31	45	70	-	46	58	-	1.22
17H150F		6F	17	68.72	67.35	45	75	-	46	58	-	1.34
18H150F		6F	18	72.77	71.39	55	79	-	46	58	-	1.59
19H150F		6F	19	76.81	75.44	60	82.5	-	46	58	-	1.80
20H150F		6F	20	80.85	79.48	62	87	-	46	58	-	2.00
21H150F		6F	21	84.89	83.52	65	91	-	46	58	-	2.20
22H150F		6F	22	88.94	87.56	68	94	-	46	58	-	2.41
23H150F		6F	23	92.98	91.61	72	97	-	46	58	-	2.66
24H150F		6F	24	97.02	95.65	72	102	-	46	58	-	2.87
25H150F		6F	25	101.06	99.69	72	106	-	46	58	-	2.70
26H150F		6F	26	105.11	103.73	80	112	-	46	58	-	3.01
27H150F		6F	27	109.15	107.78	80	115	-	46	58	-	3.21
28H150F		6F	28	113.19	111.82	80	120	-	46	58	-	3.45
30H150F		6F	30	121.28	119.90	80	128	-	46	58	-	3.91
32H150F		6F	32	129.36	127.99	80	135	-	46	58	-	4.42
34H150F		6F	34	137.45	136.07	80	142	-	46	58	-	4.97
35H150F		6F	35	141.49	140.12	80	150	-	46	58	-	5.10
36H150F		6F	36	145.53	144.16	80	150	-	46	58	-	4.06
38H150F	6F	38	153.62	152.24	80	158	-	46	58	-	4.20	
40H150F	6F	40	161.70	160.33	80	168	-	46	58	-	4.70	
44H150F	CAST IRON	6WF	44	177.87	176.50	80	184	150	46	58	19	5.06
48H150F		6WF	48	194.04	192.67	90	200	166	46	65	19	6.60
60H150		6A	60	242.55	241.18	120	-	215	46	65	19	7.80
72H150		6A	72	291.06	289.69	120	-	263	46	65	24	9.50
84H150		6A	84	339.57	338.20	120	-	312	46	65	24	11.50
96H150		6A	96	388.08	386.71	120	-	360	46	65	24	15.00
120H150		6A	120	485.10	483.73	120	-	458	46	65	24	20.50
150H150		6A	150	606.38	605.01	120	-	579	46	65	24	28.71

H200 Pilot Bore Pulley

Pulley No.		Type	teeth	Pcd	Od	Dm	Df	Di	F	L	d	Weight
14H200F	STEEL	6F	14	56.60	55.22	42	64	-	58.7	70	10	1.04
15H200F		6F	15	60.64	59.27	45	66.5	-	58.7	70	10	1.33
16H200F		6F	16	64.68	63.31	45	70	-	58.7	70	10	1.51
17H200F		6F	17	68.72	67.35	45	75	-	58.7	70	10	1.70
18H200F		6F	18	72.77	71.39	55	79	-	58.7	70	10	1.95
19H200F		6F	19	76.81	75.44	60	82.5	-	58.7	70	12	2.20
20H200F		6F	20	80.85	79.48	62	87	-	58.7	70	12	2.44
21H200F		6F	21	84.89	83.52	65	91	-	58.7	70	12	2.70
22H200F		6F	22	88.94	87.56	68	94	-	58.7	70	12	2.96
23H200F		6F	23	92.98	91.61	72	97	-	58.7	70	12	3.26
24H200F		6F	24	97.02	95.65	72	102	-	58.7	70	15	3.53
25H200F		6F	25	101.06	99.69	72	106	-	58.7	70	15	3.37
26H200F		6F	26	105.11	103.73	80	112	-	58.7	70	15	3.67
27H200F		6F	27	109.15	107.78	80	115	-	58.7	70	15	4.00
28H200F		6F	28	113.19	111.82	80	120	-	58.7	70	15	4.28
30H200F		6F	30	121.28	119.90	80	128	-	58.7	70	20	4.84
32H200F		6F	32	129.36	127.99	80	135	-	58.7	70	20	5.15
34H200F		6F	34	137.45	136.07	80	142	-	58.7	70	20	6.20
35H200F		6F	35	141.49	140.12	80	150	-	58.7	70	20	6.60
36H200F		6F	36	145.53	144.16	80	150	-	58.7	70	20	5.10
38H200F	6F	38	153.62	152.24	80	158	-	58.7	70	20	5.40	
40H200F	6F	40	161.70	160.33	80	168	-	58.7	70	20	5.80	
44H200F	CAST IRON	6WF	44	177.87	176.50	80	184	150	58.7	70	19	6.50
48H200F		6WF	48	194.04	192.67	90	200	166	58.7	75	24	7.70
60H200		6A	60	242.55	241.18	120	-	215	58.7	75	24	9.00
72H200		6A	72	291.06	289.69	120	-	263	58.7	75	28	11.60
84H200		6A	84	339.57	338.20	120	-	312	58.7	75	28	13.00
96H200		6A	96	388.08	386.71	120	-	360	58.7	75	28	18.40
120H200		6A	120	485.10	483.73	120	-	458	58.7	75	28	23.60
150H200		6A	150	606.38	605.01	120	-	579	58.7	75	28	34.56

H 1/2" Pitch

H300 Pilot Bore Pulley

Pulley No.		Type	teeth	Pcd	Od	Dm	Df	Di	F	L	d	Weight
14H300F	STEEL	6F	14	56.60	55.22	42	64	-	85.7	100	10	1.63
15H300F		6F	15	60.64	59.27	45	66.5	-	85.7	100	10	1.90
16H300F		6F	16	64.68	63.31	45	70	-	85.7	100	10	2.16
17H300F		6F	17	68.72	67.35	45	75	-	85.7	100	10	2.25
18H300F		6F	18	72.77	71.39	55	79	-	85.7	100	10	2.80
19H300F		6F	19	76.81	75.44	60	82.5	-	85.7	100	12	3.15
20H300F		6F	20	80.85	79.48	62	87	-	85.7	100	12	3.50
21H300F		6F	21	84.89	83.52	65	91	-	85.7	100	12	3.88
22H300F		6F	22	88.94	87.56	68	94	-	85.7	100	12	4.26
23H300F		6F	23	92.98	91.61	72	97	-	85.7	100	12	4.71
24H300F		6F	24	97.02	95.65	72	102	-	85.7	100	15	5.10
25H300F		6F	25	101.06	99.69	72	106	-	85.7	100	15	4.83
26H300F		6F	26	105.11	103.73	80	112	-	85.7	100	15	5.20
27H300F		6F	27	109.15	107.78	80	115	-	85.7	100	15	5.80
28H300F		6F	28	113.19	111.82	80	120	-	85.7	100	15	8.20
30H300F		6F	30	121.28	119.90	80	128	-	85.7	100	20	7.00
32H300F		6F	32	129.36	127.99	80	135	-	85.7	100	20	8.00
34H300F		6F	34	137.45	136.07	80	142	-	85.7	100	20	9.00
35H300F		6F	35	141.49	140.12	80	150	-	85.7	100	20	9.70
36H300F		6F	36	145.53	144.16	80	150	-	85.7	100	20	7.30
38H300F	6F	38	153.62	152.24	80	158	-	85.7	100	20	8.00	
40H300F	6F	40	161.70	160.33	80	168	-	85.7	100	20	8.00	
44H300	CAST IRON	6A	44	177.87	176.50	80	-	150	85.7	100	20	9.30
48H300		6A	48	194.04	192.67	90	-	166	85.7	100	20	10.40
60H300		6A	60	242.55	241.18	120	-	215	85.7	100	24	12.00
72H300		6A	72	291.06	289.69	120	-	263	85.7	100	24	14.20
84H300		6A	84	339.57	338.20	120	-	312	85.7	100	24	18.30
96H300		6A	96	388.08	386.71	120	-	360	85.7	100	24	24.00
120H300		6A	120	485.10	483.73	120	-	458	85.7	100	24	34.50
150H300		6A	150	606.38	605.01	120	-	579	85.7	100	24	40.95

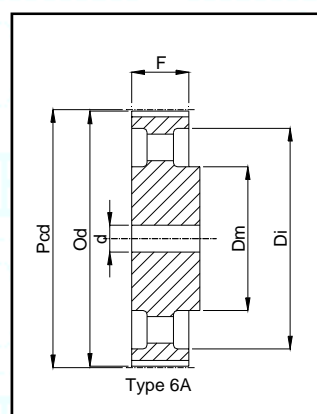
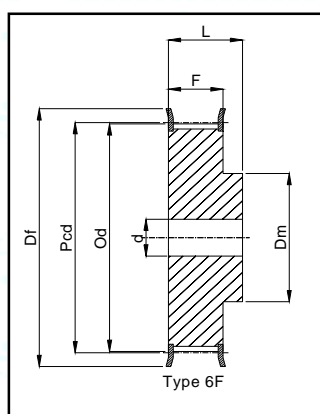

PIES H Timing Pulleys



H 1/2" Pitch

H100 Taper Lock Bore Pulley

Pulley No.	Type	teeth	Pcd	Od	Dm	Df	Di	F	L	R	Weight	
16H100F-1108	STEEL	5F	16	64.68	63.31	-	70	45	31	25	9.0	0.43
18H100F-1210		5F	18	72.77	71.39	-	79	52	31	25	6.0	0.50
19H100F-1210		5F	19	76.81	75.44	-	82.5	56	31	25	6.0	0.60
20H100F-1210		5F	20	80.85	79.48	-	87	60	31	25	6.0	0.69
21H100F-1210		5F	21	84.89	83.52	-	91	64	32	25	7.0	0.74
22H100F-1210		5F	22	88.94	87.56	-	94	67	32	25	7.0	0.83
23H100F-1610		5F	23	92.98	91.61	-	97	70	32	25	7.0	0.80
24H100F-1610		5F	24	97.02	95.65	-	102	74	32	25	7.0	0.92
25H100F-1610		5F	25	101.06	99.69	-	106	77	32	25	7.0	1.06
26H100F-1610		5F	26	105.11	103.73	-	112	82	32	25	7.0	1.20
27H100F-1610		5F	27	109.15	107.78	-	115	85	32	25	7.0	1.30
28H100F-1610		5F	28	113.19	111.82	-	120	91	32	25	7.0	1.40
30H100F-1610	5F	30	121.28	119.90	-	128	98	32	25	7.0	1.70	
32H100F-1610	5WF	32	129.36	127.99	80	135	106	32	25	7.0	1.77	
36H100F-1610	5WF	36	145.53	144.16	92	150	121	32	25	7.0	1.90	
40H100F-1610	5WF	40	161.70	160.33	92	168	138	32	25	7.0	2.20	
48H100F-1610	3WF	48	194.04	192.67	106	200	169	32	32	-	3.57	
60H100 -2012	CAST IRON	9A	60	242.55	241.18	106	-	223	34	32	1.0	4.10
72H100 -2012		9A	72	291.06	289.69	106	-	270	34	32	1.0	4.50
84H100 -2012		9A	84	339.57	338.20	106	-	318	34	32	1.0	6.90
96H100 -2517		7A	96	388.08	386.71	119	-	366	34	45	5.5	10.00
120H100-2517		7A	120	485.10	483.73	119	-	462	34	45	5.5	14.20

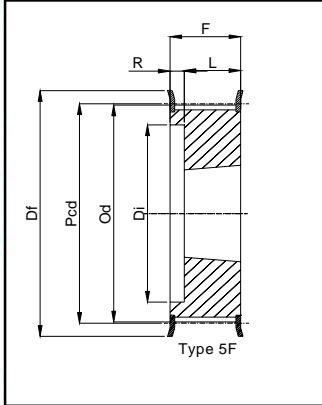

H150 Taper Lock Bore Pulley

Pulley No.		Type	teeth	Pcd	Od	Dm	Df	Di	F	L	R	Weight
18H150F-1210	STEEL	5F	18	72.77	71.39	-	79	52	45	25	20	0.63
19H150F-1210		5F	19	76.81	75.44	-	83	56	45	25	20	0.78
20H150F-1210		5F	20	80.85	79.48	-	87	60	45	25	20	0.90
21H150F-1210		5F	21	84.89	83.52	-	91	64	45	25	20	0.90
22H150F-1210		5F	22	88.94	87.56	-	94	67	45	25	20	1.04
23H150F-1610		5F	23	92.98	91.61	-	97	70	45	25	20	1.03
24H150F-1610		5F	24	97.02	95.65	-	103	74	45	25	20	1.18
25H150F-1610		5F	25	101.06	99.69	-	106	78	45	25	20	1.30
26H150F-1610		5F	26	105.11	103.73	-	112	82	45	25	20	1.45
27H150F-1610		5F	27	109.15	107.78	-	115	85	45	25	20	1.55
28H150F-1610	CAST IRON	5F	28	113.19	111.82	-	120	91	45	25	20	1.70
30H150F-1610		5F	30	121.28	119.90	-	128	98	45	25	20	2.00
32H150F-1610		5WF	32	129.36	127.99	80	135	106	45	25	20	2.06
36H150F-1610		5WF	36	145.53	144.16	92	150	121	45	25	20	2.60
40H150F-1610		5WF	40	161.70	160.33	92	168	138	45	25	20	2.70
48H150F-2012		5WF	48	194.04	192.67	106	200	169	45	32	13	3.54
60H150 -2012	CAST IRON	9A	60	242.55	241.18	106	-	223	46	32	7	5.20
72H150 -2012		9A	72	291.06	289.69	106	-	270	46	32	7	5.40
84H150 -2012		9A	84	339.57	338.20	106	-	320	46	32	7	8.00
96H150 -2517		9A	96	388.08	386.71	119	-	368	46	45	0.5	10.50
120H150-2517		9A	120	485.10	483.73	119	-	462	46	45	0.5	15.40

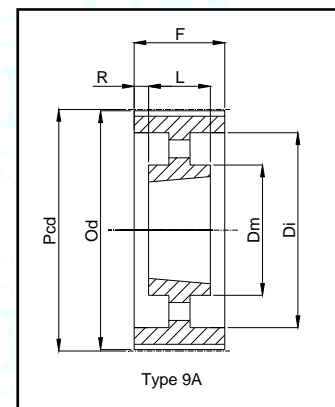
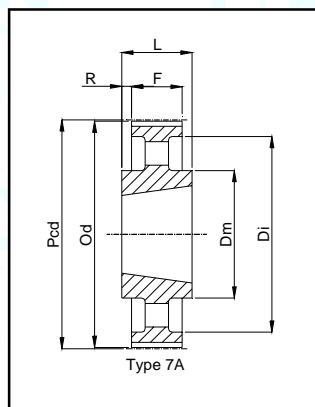
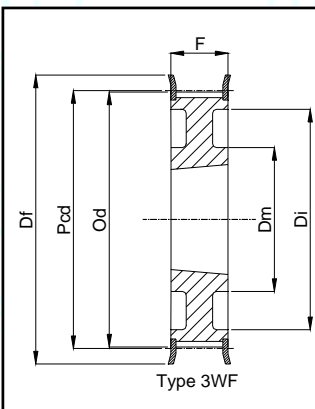
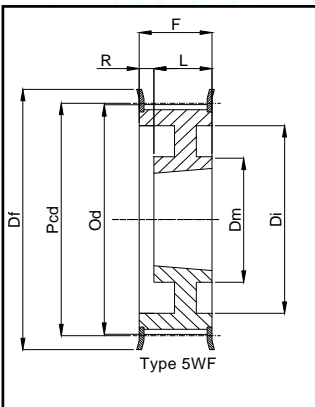

H 1/2" Pitch

H200 Taper Lock Bore Pulley

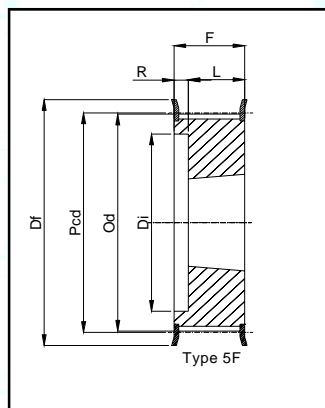

Pulley No.	Type	teeth	Pcd	Od	Dm	Df	Di	F	L	R	Weight
18H200F-1210	STEEL	5F 18	72.77	71.39	-	79	52	58	25	33.0	0.84
19H200F-1610		5F 19	76.81	75.44	-	83	56	58	25	33.0	0.81
20H200F-1610		5F 20	80.85	79.48	-	87	62	58	25	33.0	1.00
21H200F-1610		5F 21	84.89	83.52	-	91	64	58	25	33.0	0.98
22H200F-1610		5F 22	88.94	87.56	-	94	67	58	25	33.0	1.20
23H200F-1610		5F 23	92.98	91.61	-	97	70	58	25	33.0	1.24
24H200F-1610		5F 24	97.02	95.65	-	102	74	58	25	33.0	1.42
25H200F-1610		5F 25	101.06	99.69	-	106	77	58	25	33.0	1.50
26H200F-1610		5F 26	105.11	103.73	-	112	82	58	25	33.0	1.65
27H200F-1610		5F 27	109.15	107.78	-	115	85	58	25	33.0	1.84
28H200F-1610	CAST IRON	5F 28	113.19	111.82	-	120	91	58	25	33.0	2.00
30H200F-1610		5F 30	121.28	119.90	-	128	98	58	25	33.0	2.30
32H200F-2012		5F 32	129.36	127.99	-	135	106	58	32	26.0	2.65
36H200F-2012		5WF 36	145.53	144.16	102	150	121	58	32	26.0	3.20
40H200F-2012		5WF 40	161.70	160.33	106	168	138	58	32	26.0	3.50
48H200F-2517		5WF 48	194.04	192.67	119	200	168	58	45	13.0	4.60
60H200 -2517		9A 60	242.55	241.18	119	-	223	60	45	7.5	5.80
72H200 -2517		9A 72	291.06	289.69	119	-	270	60	45	7.5	6.80
84H200 -2517		9A 84	339.57	338.20	119	-	320	60	45	7.5	9.50
96H200 -2517		9A 96	388.08	386.71	119	-	368	60	45	7.5	10.00
120H200-2517		9A 120	485.10	483.73	119	-	462	60	45	7.5	17.50

H300 Taper Lock Bore Pulley

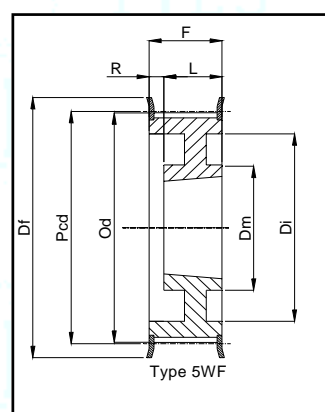

Pulley No.	Type	teeth	Pcd	Od	Dm	Df	Di	F	L	R	Weight
20H300F-1615	STEEL	4F 20	80.85	79.48	-	87	65	84	38	23.0	1.20
21H300F-1615		4F 21	84.89	83.52	-	91	65	84	38	23.0	1.40
22H300F-1615		4F 22	88.94	87.56	-	94	67	84	38	23.0	1.65
23H300F-1615		4F 23	92.98	91.61	-	97	70	84	38	23.0	1.85
24H300F-1615		4F 24	97.02	95.65	-	102	74	84	38	23.0	2.05
25H300F-1615		4F 25	101.06	99.69	-	106	77	84	38	23.0	2.25
26H300F-1615		4F 26	105.11	103.73	-	112	82	84	38	23.0	2.47
27H300F-2012		4F 27	109.15	107.78	-	115	85	84	32	26.0	2.20
28H300F-2012		4F 28	113.19	111.82	-	120	91	84	32	26.0	2.50
30H300F-2012		4F 30	121.28	119.90	-	128	98	84	32	26.0	2.90
32H300F-2517	CAST IRON	4F 32	129.36	127.99	-	135	106	84	45	19.5	3.30
36H300F-2517		4F 36	145.53	144.16	-	150	121	84	45	19.5	4.60
40H300F-2517		4F 40	161.70	160.33	-	168	138	84	45	19.5	6.00
48H300F-2517		4WF 48	194.04	192.67	119	200	165	86	45	20.5	6.00
60H300 -2517		9A 60	242.55	241.18	119	-	223	86	45	20.5	6.80
72H300 -2517		9A 72	291.06	289.69	119	-	270	86	45	20.5	7.80
84H300 -2517		9A 84	339.57	338.20	119	-	318	86	45	20.5	12.00
96H300 -3030		9A 96	388.08	386.71	150	-	362	86	76	5.0	18.20
120H300-3030		9A 120	485.10	483.73	150	-	460	86	76	5.0	24.00

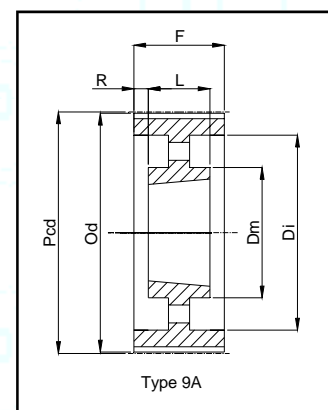
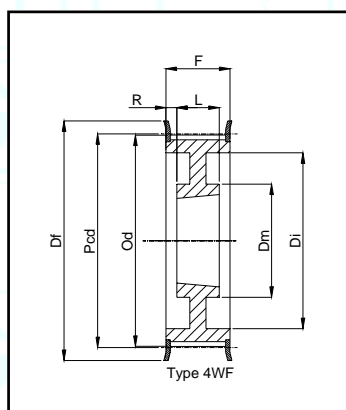
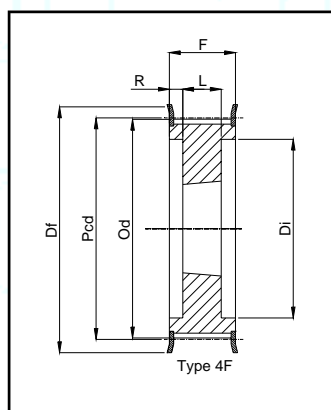

PIES XH / XXH Rubber Timing Belts



XH EXTRA HEAVY PITCH 7/8" (22.225mm)

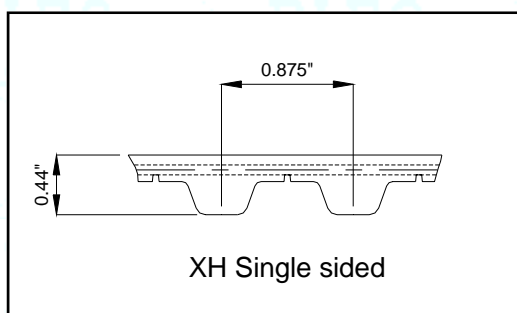

- In-between lengths are available, minimum quantity may apply.
- Also available in Polyurethane, minimum quantity may apply.
- Non-standard widths available.
- Contact sales department for prices

Pulley dimensions on next page.
Pulleys are non-stocked and are made to order.

Standard Belt widths	2" = 200	3" = 300	4" = 400	5" = 500
Example Part Number	980XH300			
980	98.0" Pitch length			
XH	Extra Heavy Pitch type			
300	3.00" Wide			

Belt No	Length	No. Of
Single Sided		
507XH	50.75	58
560XH	56.00	64
630XH	63.00	72
700XH	70.00	80
770XH	77.00	88
840XH	84.00	96
980XH	98.00	112
1120XH	112.00	128
1260XH	126.00	144
1400XH	140.00	160
1540XH	154.00	176
1750XH	175.00	200

XXH DOUBLE EXTRA HEAVY PITCH 1.25" (31.75mm)

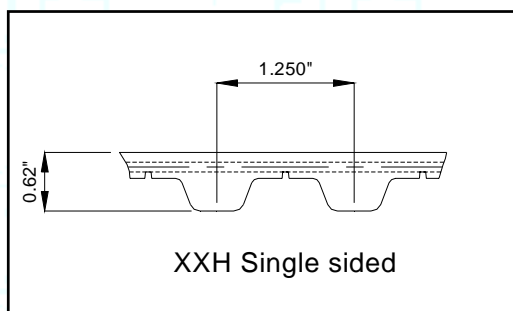

- In-between lengths are available, minimum quantity may apply.
- Also available in Polyurethane, minimum quantity may apply.
- Non-standard widths available.
- Contact sales department for prices

For Pulley dimensions please contact our sales department.
Pulleys are non-stocked and are made to order.

Standard Belt widths	2" = 200	3" = 300	4" = 400	5" = 500
Example Part Number	1000XXH400			
100.0"	100.0" Pitch length			
XXH	Double Extra Heavy Pitch type			
400	4.00" Wide			

Belt No	Length	No. Of
Single Sided		
700 XXH	70	56
800 XXH	80	64
900 XXH	90	72
1000 XXH	100	80
1200 XXH	120	96
1400 XXH	140	112
1600 XXH	160	128
1800 XXH	180	144

PIES XH Timing Pulleys



XH200 Pilot Bore Pulley

XH 7/8" Pitch

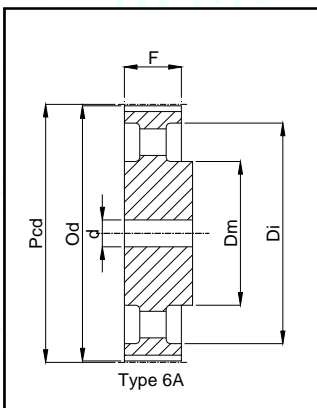
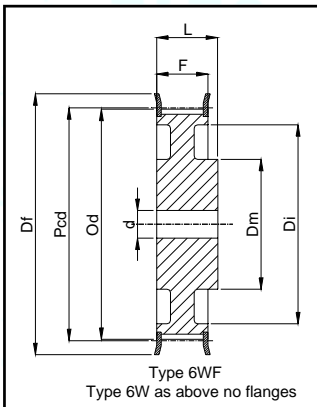
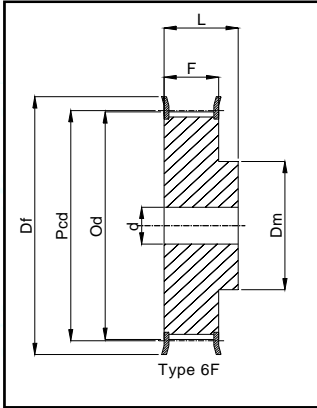

Pulley No.	Type	teeth	Pcd	Od	Dm	Df	Di	F	L	d	Weight
18XH200F	6F	18	127.34	124.55	100	138	-	63.2	80	24	5.8
19XH200F	6F	19	134.41	131.62	100	146	-	63.2	80	24	6.7
20XH200F	6F	20	141.49	138.69	100	154	-	63.2	80	24	7.1
21XH200F	6F	21	148.56	145.77	110	160	-	63.2	80	24	8.0
22XH200F	6F	22	155.64	152.84	110	168	-	63.2	80	24	8.8
24XH200F	6F	24	169.79	166.99	120	183	-	63.2	80	24	10.4
25XH200F	6F	25	176.86	174.07	120	188	-	63.2	80	24	11.3
26XH200F	6F	26	183.94	181.14	120	198	-	63.2	80	24	12.2
27XH200F	6F	27	191.01	188.22	120	200	-	63.2	80	24	13.0
28XH200F	6F	28	198.08	195.29	150	211	-	63.2	80	24	15.0
30XH200F	6F	30	212.23	209.44	150	226	-	63.2	80	24	16.8
32XH200F	6WF	32	226.38	223.59	150	240	194	63.2	80	24	14.5
34XH200F	6WF	34	240.53	237.74	150	256	198	63.2	80	24	21.0
38XH200F	6WF	38	268.83	266.03	150	286	227	63.2	100	28	28.0
40XH200F	6WF	40	282.98	280.18	150	296	241	63.2	100	28	22.5
46XH200	6W	46	325.42	322.63	150	-	283	63.2	100	28	26.5
48XH200	6W	48	339.57	336.78	150	-	297	63.2	100	28	26.8
58XH200	6W	58	410.32	407.52	150	-	368	63.2	100	28	37.4
60XH200	6W	60	424.47	421.67	150	-	382	63.2	100	28	31.5
70XH200	6A	70	495.21	492.42	190	-	453	63.2	100	28	41.1
72XH200	6A	72	509.36	506.56	190	-	467	63.2	100	28	43.0
78XH200	6A	78	551.81	549.01	190	-	510	63.2	100	28	50.1
80XH200	6A	80	565.95	563.16	190	-	524	63.2	100	28	55.0
82XH200	6A	82	580.10	577.31	190	-	538	63.2	100	28	54.9
84XH200	6A	84	594.25	591.46	190	-	552	63.2	100	28	54.6
94XH200	6A	94	665.00	662.20	190	-	623	63.2	100	28	68.5
96XH200	6A	96	679.15	676.35	190	-	637	63.2	100	28	61.0
118XH200	6A	118	834.78	831.99	190	-	792	63.2	100	28	101.1
120XH200	6A	120	848.93	846.14	190	-	806	63.2	100	28	105.2

XH300 Pilot Bore Pulley

Pulley No.	Type	teeth	Pcd	Od	Dm	Df	Di	F	L	d	Weight
18XH300F	6F	18	127.34	124.55	100	138	-	90.4	110	24	8.0
19XH300F	6F	19	134.41	131.62	100	146	-	90.4	110	24	8.8
20XH300F	6F	20	141.49	138.69	100	154	-	90.4	110	24	9.6
21XH300F	6F	21	148.56	145.77	110	160	-	90.4	110	24	11.0
22XH300F	6F	22	155.64	152.84	110	168	-	90.4	110	24	12.0
24XH300F	6F	24	169.79	166.99	120	183	-	90.4	110	24	14.4
25XH300F	6F	25	176.86	174.07	120	188	-	90.4	110	24	15.6
26XH300F	6F	26	183.94	181.14	120	198	-	90.4	110	24	16.2
27XH300F	6F	27	191.01	188.22	120	200	-	90.4	110	24	18.2
28XH300F	6F	28	198.08	195.29	150	211	-	90.4	110	24	20.4
30XH300F	6F	30	212.23	209.44	150	226	-	90.4	110	24	23.0
32XH300F	6F	32	226.38	223.59	150	240	-	90.4	110	24	26.5
34XH300F	6WF	34	240.53	237.74	150	256	198	90.4	110	24	29.0
38XH300F	6WF	38	268.83	266.03	150	286	227	90.4	120	28	37.5
40XH300F	6WF	40	282.98	280.18	150	296	241	90.4	120	28	29.0
46XH300	6W	46	325.42	322.63	150	-	283	92.1	120	28	32.0
48XH300	6W	48	339.57	336.78	150	-	297	92.1	120	28	32.8
58XH300	6W	58	410.32	407.52	150	-	368	92.1	120	28	45.0
60XH300	6W	60	424.47	421.67	150	-	382	92.1	120	28	39.0
70XH300	6A	70	495.21	492.42	190	-	453	92.1	120	28	46.2
72XH300	6A	72	509.36	506.56	190	-	467	92.1	120	28	54.0
78XH300	6A	78	551.81	549.01	190	-	510	92.1	120	28	63.2
80XH300	6A	80	565.95	563.16	190	-	524	92.1	120	28	63.0
82XH300	6A	82	580.10	577.31	190	-	538	92.1	120	28	67.1
84XH300	6A	84	594.25	591.46	190	-	552	92.1	120	28	69.2
94XH300	6A	94	665.00	662.20	190	-	623	92.1	120	28	82.7
96XH300	6A	96	679.15	676.35	190	-	637	92.1	120	28	80.4
118XH300	6A	118	834.78	831.99	190	-	792	92.1	120	28	120.5
120XH300	6A	120	848.93	846.14	190	-	806	92.1	120	28	125.3

XH 7/8" Pitch

XH400 Pilot Bore Pulley

Pulley No.	Type	teeth	Pcd	Od	Dm	Df	Di	F	L	d	Weight
18XH400F	6F	18	127.34	124.55	100	138	-	117.3	132	32	9.5
19XH400F	6F	19	134.41	131.62	100	146	-	117.3	132	32	10.6
20XH400F	6F	20	141.49	138.69	100	154	-	117.3	132	32	11.9
21XH400F	6F	21	148.56	145.77	110	160	-	117.3	132	32	13.4
22XH400F	6F	22	155.64	152.84	110	168	-	117.3	132	32	14.6
24XH400F	6F	24	169.79	166.99	120	183	-	117.3	132	32	17.5
25XH400F	6F	25	176.86	174.07	120	188	-	117.3	132	32	19.0
26XH400F	6F	26	183.94	181.14	120	198	-	117.3	132	32	20.8
27XH400F	6F	27	191.01	188.22	120	200	-	117.3	132	32	22.5
28XH400F	6F	28	198.08	195.29	150	211	-	117.3	132	32	25.0
30XH400F	6F	30	212.23	209.44	150	226	-	117.3	132	32	28.4
32XH400F	6F	32	226.38	223.59	150	240	-	117.3	132	32	32.5
34XH400F	6F	34	240.53	237.74	150	256	-	117.3	132	32	37.0
38XH400F	6WF	38	268.83	266.03	150	286	227	117.3	132	32	40.0
40XH400F	6WF	40	282.98	280.18	150	296	241	117.3	132	32	34.5
46XH400	6W	46	325.42	322.63	150	-	283	119.1	132	32	40.5
48XH400	6W	48	339.57	336.78	150	-	297	119.1	132	32	39.0
58XH400	6W	58	410.32	407.52	150	-	368	119.1	132	32	51.5
60XH400	6W	60	424.47	421.67	150	-	382	119.1	132	32	50.0
70XH400	6A	70	495.21	492.42	190	-	453	119.1	132	32	63.2
72XH400	6A	72	509.36	506.56	190	-	467	119.1	132	32	62.0
78XH400	6A	78	551.81	549.01	190	-	510	119.1	132	32	73.2
80XH400	6A	80	565.95	563.16	190	-	524	119.1	132	32	85.0
82XH400	6A	82	580.10	577.31	190	-	538	119.1	132	32	77.6
84XH400	6A	84	594.25	591.46	190	-	552	119.1	132	32	66.5
94XH400	6A	94	665.00	662.20	190	-	623	119.1	132	32	95.3
96XH400	6A	96	679.15	676.35	190	-	637	119.1	132	32	94.0
118XH400	6A	118	834.78	831.99	190	-	792	119.1	132	32	138.4
120XH400	6A	120	848.93	846.14	190	-	806	119.1	132	32	143.9

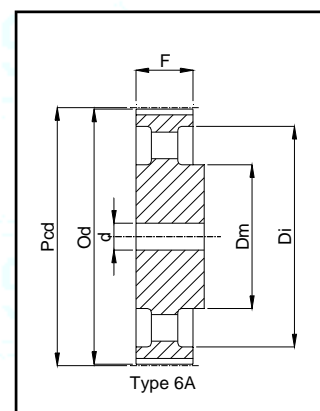
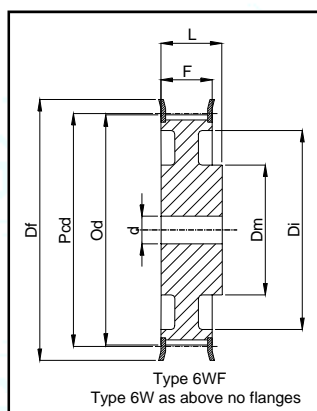
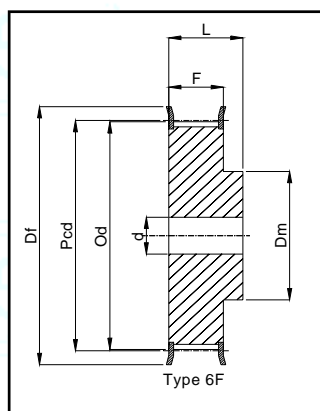

PIES XH Timing Pulleys



XH 7/8" Pitch

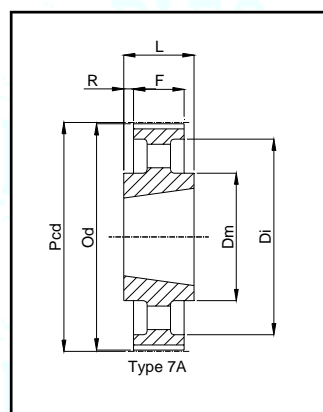
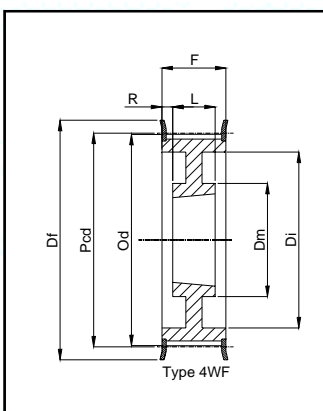
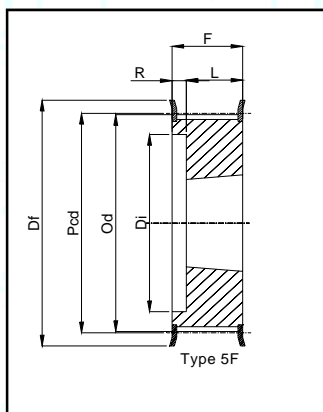

XH200 Taper Lock Bore Pulley

Pulley No.	Type	teeth	Pcd	Od	Dm	Df	Di	F	L	R
18XH200F-2517	5F	18	127.34	124.55	-	138	95	64	45	19.0
20XH200F-2517	5F	20	141.49	138.69	-	154	110	64	45	19.0
22XH200F-2517	5F	22	155.64	152.84	-	168	120	64	45	19.0
24XH200F-2517	5F	24	169.79	166.99	-	183	135	64	45	19.0
26XH200F-2517	5F	26	183.94	181.14	-	198	150	64	45	19.0
28XH200F-2517	4WF	28	198.08	195.29	120	211	165	64	45	9.5
30XH200F-2517	4WF	30	212.23	209.44	120	226	180	64	45	9.5
32XH200F-2517	4WF	32	226.38	223.59	120	240	195	64	45	9.5
40XH200F-3020	4WF	40	282.98	280.18	160	296	245	64	51	6.5
48XH200 - 3020	9W	48	339.57	336.78	160	-	300	64	51	6.5
60XH200 - 3535	7A	60	424.47	421.67	190	-	385	64	89	12.5
72XH200 - 3535	7A	72	509.36	506.56	190	-	470	64	89	12.5
84XH200 - 3535	7A	84	594.25	591.46	190	-	555	64	89	12.5
96XH200 - 3535	7A	96	679.15	676.35	190	-	640	64	89	12.5
120XH200-3535	7A	120	848.93	846.14	190	-	810	64	89	12.5

XH300 Taper Lock Bore Pulley

Pulley No.	Type	teeth	Pcd	Od	Dm	Df	Di	F	L	R
18XH300F-2517	5F	18	127.34	124.55	-	138	95	90	45	45.0
20XH300F-2517	5F	20	141.49	138.69	-	154	110	90	45	45.0
22XH300F-2517	5F	22	155.64	152.84	-	168	120	90	45	45.0
24XH300F-2517	5F	24	169.79	166.99	-	183	135	90	45	45.0
26XH300F-2517	5F	26	183.94	181.14	-	198	150	90	45	45.0
28XH300F-3020	5F	28	198.08	195.29	-	211	165	90	51	39.0
30XH300F-3020	5F	30	212.23	209.44	-	226	180	90	51	39.0
32XH300F-3020	5F	32	226.38	223.59	-	240	195	90	51	39.0
40XH300F-3020	4WF	40	282.98	280.18	160	296	245	90	51	19.5
48XH300 - 3020	9W	48	339.57	336.78	160	-	300	90	51	19.5
60XH300 - 3535	9A	60	424.47	421.67	190	-	385	90	89	0.5
72XH300 - 3535	9A	72	509.36	506.56	190	-	470	90	89	0.5
84XH300 - 4040	7A	84	594.25	591.46	230	-	555	90	102	6.0
96XH300 - 4040	7A	96	679.15	676.35	230	-	640	90	102	6.0
120XH300-4040	7A	120	848.93	846.14	230	-	810	90	102	6.0

XH400 Taper Lock Bore Pulley

Pulley No.	Type	teeth	Pcd	Od	Dm	Df	Di	F	L	R
18XH400F-2517	5F	18	127.34	124.55	-	138	95	119	45	74.0
20XH400F-2517	5F	20	141.49	138.69	-	154	110	119	45	74.0
22XH400F-2517	5F	22	155.64	152.84	-	168	120	119	45	74.0
24XH400F-3020	5F	24	169.79	166.99	-	183	135	119	51	68.0
26XH400F-3020	5F	26	183.94	181.14	-	198	150	119	51	68.0
28XH400F-3020	5F	28	198.08	195.29	-	211	165	119	51	68.0
30XH400F-3020	5F	30	212.23	209.44	-	226	180	119	51	68.0
32XH400F-3020	5F	32	226.38	223.59	-	240	195	119	51	68.0
40XH400F-3535	4WF	40	282.98	280.18	190	296	245	119	89	15.0
48XH400 - 3535	9W	48	339.57	336.78	190	-	300	119	89	15.0
60XH400 - 4040	9A	60	424.47	421.67	230	-	385	119	102	8.5
72XH400 - 4040	9A	72	509.36	506.56	230	-	470	119	102	8.5
84XH400 - 4040	9A	84	594.25	591.46	230	-	555	119	102	8.5
96XH400 - 4040	9A	96	679.15	676.35	230	-	640	119	102	8.5
120XH400-4040	9A	120	848.93	846.14	230	-	810	119	102	8.5

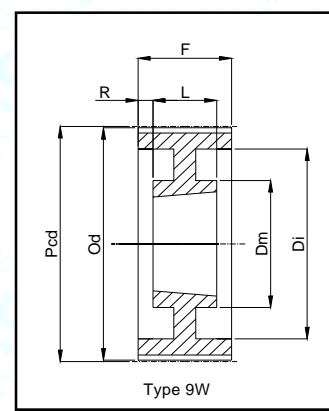
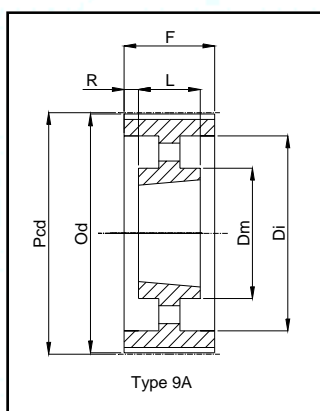

NOTES



PIES Australia are also suppliers of:

- **Synchroflex Timing Belts & Pulleys**
- **Breco & Brecoflex Timing Belts**
- **Goodyear Industrial Air Springs**
- **Goodyear Automotive Air Springs**
- **Poggi Right Angle Gearboxes**
- **AeroGo Aerocastors**
- **Locking Devices**
- **24 Hour Breakdown Service**

Distributed by

P.I.E.S. AUSTRALIA PTY LTD

49 Freight Drive, Somerton

Tel: 03 9303 2000 Fax: 03 9303 2099

www.piesau.com.au

sales@piesau.com.au